



**REKAYASA
ENGINEERING**
YOUR ENGINEERING PARTNER

COMPANY P R O F I L E

www.rekayasaengineering.co.id

Subsidiary of



CONTENS

| | |
|---------------------------------|-------|
| HISTORY | 03 |
| VISION MISSION | 03 |
| THE COMPANY | 04 |
| CORPORATE CULTURE | 05 |
| REKAYASA GROUP | 06 |
| SUBSIDIARY | 07 |
| SERVICES | 08 |
| PRODUCTS (SCOPE OF WORK) | 09 |
| MARKET SEGMENTATION | 10 |
| PROJECT PROFILE | 11-15 |
| QUALITY POLICY & CERTIFICATION | 16 |
| HEALTH AND SAFETY ENVIRONMENT | 17 |
| CORPORATE SOCIAL RESPONSIBILITY | 17 |
| ENGINEERING SOFTWARE | 18 |
| CLIENTS & PARTNERS | 19 |

HISTORY

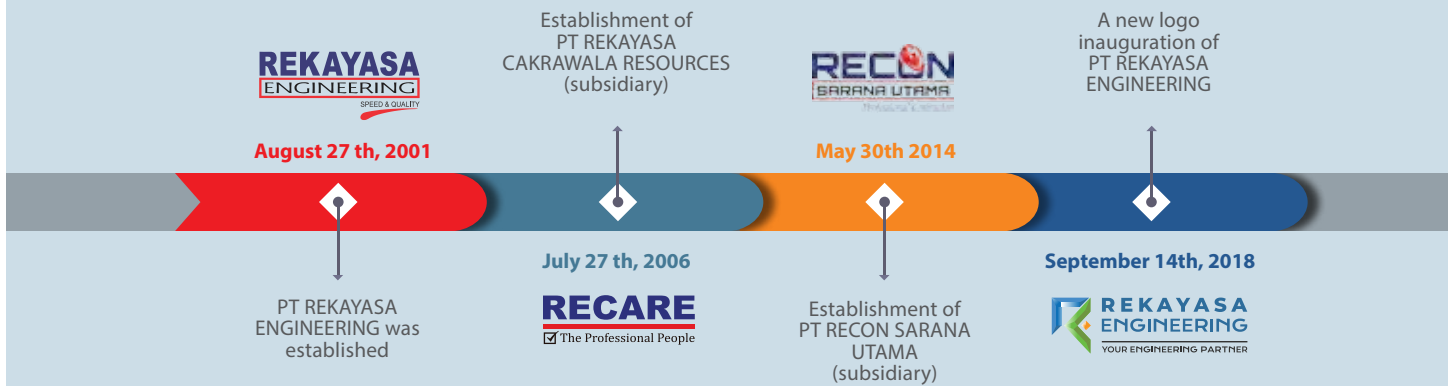

VISION

To become a leading Engineering Company in Innovation and Quality as well as to become a solid competitive company within a global business area.

MISSION

To increase the competitiveness in providing added values and in maximizing customer satisfaction, as well as in encouraging the improvement of partnership that is profitable for both sides.

To provide the best engineering services for customers by putting forward the innovation and quality of designed product to its optimum through an effective and efficient production.

To give benefits and good company image to the stakeholders.

THE COMPANY

REKAYASA ENGINEERING (RE) was established in August 27th 2001 as a subsidiary of REKAYASA INDUSTRI and has gradually evolved from a Profit Centre of Detailed Engineering with only a handful of employees to become a multi-service engineering firm that now employs hundreds of people. The establishment is an effort to improve our competence in engineering area to serve wider industrial markets and to expand prospective engineering business in future.

Nowadays, RE can also provide Basic Engineering & Field Engineering, Front End Engineering Design (FEED), and EPC Services in a wide range of engineering services area, as follows: Oil & Gas, Geothermal & Power plant, Chemical & Petrochemical, Mining & Infrastructure, Agro industry and Other Industries.

Our goal is to provide the best engineering services for client through value creation, innovation, and continuous improvement. Signifying our continuous strive toward

excellence, SUCOFINDO International Certification Services approved and certified RE for ISO 9001:2015 and ISO 45001:2018, namely integrated Quality Management System and Occupational Health & Safety Management System Certification for Engineering and Inspection Services for Process, Piping, Instrument, Electrical, Mechanical and Civil.

RE committed to its clients "efficient service at the most competitive cost, on-time delivery of commitments, and confidence on their quality", which also as the main basis of its customers service and quality policy. Its unfailing commitment in achieving excellence and stringent quality controls, together with the application of the state - of the - art of engineering technologies, has firmly established RE as a new high competent engineering company.

Armed with a competitive strategy and global certification of its capabilities, RE surges forward in its vision to become a

CORPORATE CULTURE



■ SOLIDITY

Team up based on mutual trust and complementarity to achieve company goals.

■ PROFESSIONALISM

Always build a professional working relationship with emphasis on speed, accuracy and quality.

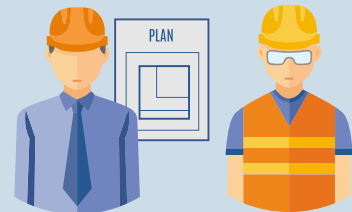

■ INTEGRITY

Creating an integrity as the foundation and main pillar in running a business enterprise.

■ TRUST

The corporation always maintaining and fostering the trust that has been given, to increase added value to the employer (client) and other stakeholder.



REKAYASA GROUP



SUBSIDIARY



SERVICES



Engineering

- Front End Engineering Design (FEED)
- Basic Engineering Design
- Detailed Engineering Design
- Field Engineering Services

Inspection & Supervision

Our Subsidiaries



- EPC Electrical & Instrument
- EPC Tank
- HVAC
- ME Building

RE CARE

✓ The Professional People

- Engineering School Center
- Workshop Training & Development
- Certification
- Man Power Supply

RE can handle any plant design engineering job, whether it is large or small, from start to finish. Our experienced staffs are capable of carrying out FEED, basic and detailed engineering. These services are adequately by a project team, organized for individual jobs to assure perfect project management involving schedule, cost and quality control.

During design engineering phase, it can be divided into two parts: Basic design

is to transform the production process description to engineering documents by creating process flow diagrams, plot plans and piping and instrument diagrams, determining project specifications, and drawing up preliminary operating manuals. Detailed design encompasses structural design, layout and detailed design for civil, architectural, mechanical, piping, electrical and instrumentation work.

During construction phase, RE can provide Field Engineer, inspection and Supervision Services. Then continue perform and finalize the engineering services to ensure necessary information is available for procurement, construction, installation, fabrication and other field execution, commissioning, start-up and integration activities. It can also make any required revisions to design and drawings to take into account evolving circumstances during the construction and as built drawing after construction is finished.

Construction Inspection and Supervision is to manage, direct and monitor all construction activities to align with safety, schedule and quality based on contract agreement.

To generate the projects, RE will provide a solid engineering team from multi disciplines (Process, Instrument, Electrical, Mechanical, Piping and Civil Engineering) and utilize the latest technology in 3-D

PRODUCTS (SCOPE OF WORK)



PROCESS & PROCESS SAFETY

PFD, PID, Line Index, Equipment List, Hydraulic Calculation, Hazard Operability Study, etc



MECHANICAL

Design Basis, Specification Calculation, Data Sheet, Equipment List, Drawing, MTO, Standard Drawing, General Detail & Shop Fabrication, Requisition, TBE, VPC, Study Analysis Report, etc.



PIPING & 3D DESIGN

Layout Drawing, Isometric Drawing, Requisition, Flexibility Analysis, Information Drawing, Test Block Diagram, MTO, etc



CIVIL & STRUCTURE

Structural Analysis, Foundation Analysis, Design & Construction Specification, Architectural Design, Standard & Eng. Drawing, Requisition (Material & Construction) Shop Drawing, MTO, etc.



ELECTRICAL

Cabling & Wiring Layout, Lighting Design, Grounding Design, Fire Alarm Design, Communication Design, MTO, etc.



INSTRUMENT

Layout Drawing, Loop Diagram, Hook-up Tubing, Connection List/Termination Diagram, Cable/Cable Drum Schedule, etc.

MARKET SEGMENTATION

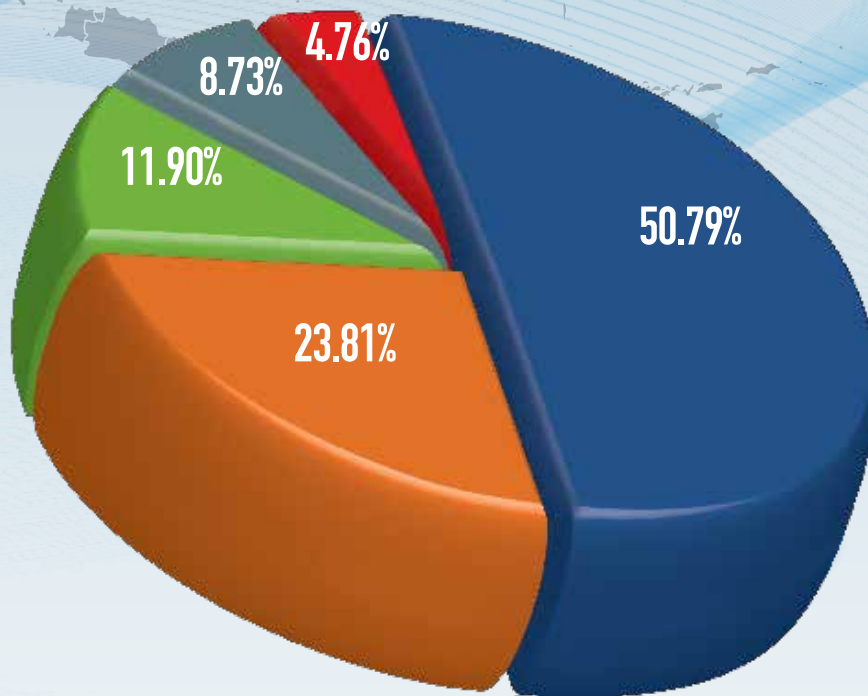

TOTAL 240 PROJECTS

50.79% PROJECTS

OIL & GAS

23.81% PROJECTS

GEO THERMAL & POWER PLANT

11.90% PROJECTS

CHEMICAL & PETROCHEMICAL

4.76% PROJECTS

MINING & INFRASTRUCTURE

8.73% PROJECTS

AGRO INDUSTRY & OTHER INDUSTRIES

PROJECT PROFILE

OIL AND GAS



Detailed Engineering Civil, Mechanical HVAC and Electrical PPGM Donggi Project for Package I, II and III from 2013 – 2015

Owner

SKK Migas & Pertamina EP / PT.Rekayasa Industri

Location

Donggi Senoro, Central Sulawesi

Project Brief

Detail Engineering Work of multi disciplines for a new gas processing facilities with design capacity of 60 MMSCFD and minimum sales gas pressure 850 psig

Balangan Blue Sky

Owner

PT Pertamina (Persero) / PT Rekayasa Industri

Location

Balangan, Indramayu, West Java

Project Brief

Detailed Engineering Work of multi disciplines for a new expansion oil refinery and pipelines with production capacity of 52,000 Barrel daily



Engineering Services Facilities EOR

Owner

PT Pertamina EP

Location

Indonesia, period 2016-2019

Project Brief

Includes all AFE project work associated with the production, injection and other supporting facilities are carried out by Surface Function Facilities EOR

VICO Engineering Services

Owner

VICO Indonesia

Location

East Kalimantan

Project Brief

Detail Engineering for Civil, Piping, Electrical, Instrument & Mechanical with Modification and Expansion



GEO THERMAL & POWER PLANT



Reaktor Daya Eksperimental May - December 2015 With Capacity 10 MWth (thermal) and 3 Mwe Electric)

Client / Owner

BATAN (Badan Tenaga Nuklir Nasional)

Location

Puspitek Serpong, Tangerang

Project Brief

Provide consulting services of Preliminary Engineering Design Preparation of Experimental Power Reactor, in consortium with PT Kogas Driyap Konsultan & Nukem Technologies GmbH

Ulubelu 3 & 4 Project

Client / Owner

PT Rekayasa Industri/ PT PGE

Location

Ulubelu, Lampung

Project Brief

Detail Engineering for Civil, Piping, Electrical, Instrument & Mechanical with Capacity 2x55 MW



Kamojang 5

Client / Owner

PT Rekayasa Industri / PT PGE

Location

Garut, West Java

Project Brief

Detail Engineering for Civil, Piping, Electrical, Instrument & Mechanical with Capacity 35 MW

Lahendong 5 & 6

Client / Owner

PT Rekayasa Industri / PT PGE

Location

Tompaso, North Sulawesi

Project Brief

Detail Engineering Work of multi disciplines for geothermal power plant with capacity of 2x20 MW



PROJECT CHEMICAL & PETROCHEMICAL



OSBL TDAE Processing Plant Project

Client / Owner

PT Enerco RPO International

Location

Batam

Project Brief

Provision of Detail Engineering Multi Discipline

Jasa Konsultasi FEED Standar Desain Pembangunan Terminal Aspal Curah

Client / Owner

PT Pertamina (Persero)

Location

Jakarta

Project Brief

Front End Engineering Design Work of multi disciplines for design standard of Asphalt Storage Terminal with capacity of 4 x 5000 MT, complete with receiver, storage and distribution facility

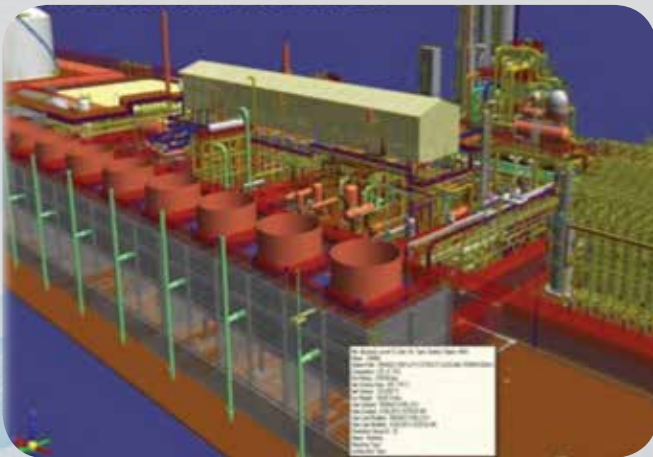

PUSRI 2B

Client / Owner

PT Rekayasa Industri / PT Pupuk Sriwidjaya

Location

Palembang, South Sumatera

Project Brief

Detail Engineering for civil, Piping, Electrical, Instrument &Mechanica - Piping Using SP3D and Supervision for Constructionl

MINING & INFRASTRUCTURE



Engineering Services for Freeport

Client / Owner

PT Freeport Indonesia

Location

Timika

Project Brief

Any and all other design Engineering Services

On Call Engineering Services

Client / Owner

PT Vale Indonesia

Location

Sorowako, Sulawesi

Project Brief

Any and all other design Engineering Services



Jasa Perencanaan & Rekayasa Konstruksi TSL Furnace Ausmelt di Unit Metalurgi Muntol - Bangka Barat

Client / Owner

PT Timah

Location

Bangka Belitung

Project Brief

Any and all other design Engineering Services



Detailed Engineering Design & Field Engineering TUBAN IV

Client / Owner

PT Prosys Bangun Persada / Semen Gresik

Location

Tuban, East Java

Project Brief

Detail Engineering Work of multi disciplines & Field Engineering pada EPC service 2,5 Million Metric Ton Per Year New Cement Plant Project



AGRO INDUSTRY & OTHER INDUSTRIES



MECH2 APH Engineering Assessment

Client / Owner

PT CABOT Indonesia

Location

Cilegon

Project Brief

Provision of Detail Engineering Assessment

Engineering Services For PM#2 Modification

Client / Owner

PT Bukit Muria Jaya

Location

Jakarta

Project Brief

Provision of Detail Engineering multi discipline



Revitalisasi PT Kertas Kraft Aceh (PT KKA)

Client / Owner

PT KKA (Kertas Kraft Aceh)

Location

Aceh

Project Brief

Provision of Detail Engineering Multi Discipline



QUALITY POLICY



- Seeking optimal performance of the company to get the best financial condition for the company.
- Putting customer satisfaction as top priority in the company objectives achievement.
- Increasing continually the competence, productivity and effectiveness of the company in producing qualified and timely engineering services.
- Maintaining cooperative relationship and provide value added services to customers, through product innovation and quality design.



CERTIFICATION





HEALTH, SAFETY & ENVIRONMENT

The Management of RE commits to perform the company's business activities based on good Health Safety Environment.

It is the Management's full responsibility to ensure that every employee carries out prevention of material and non-material losses by implementing in and paying attention to Health Safety Environment aspect to increase competitiveness and added value for the company in dealing with global competition.

Therefore, the Management of RE commits:

1. To achieve zero accident vision and the company's main targets, namely zero in death, disease, and environmental pollution caused by the company's business execution;
2. To become example and model and at all times promote the implementation of the Management System of Health Safety and Environment Protection in the company;
3. To boost competence enhancement by all employees relating to the continual implementation of the Management System of Health Safety and Environment Protection in the company's environment;
4. To put HSEP aspects as the foremost

part of all employees' assessment, business partner selection who will work in the company's environment, and the company's performance measurement in order to uplift the company's competitiveness;

5. To encourage environment awareness in every activity;
6. To require the investigation to each work accident, disease, and environment pollution resulted by the company's business execution and ensure the follow-ups as preventive measures;
7. To give continual appreciation and reward as well as sanction in the implementation of the Management System of Health Safety and Environment Protection.

The Management of RE agrees and approves to carry out these commitments, and recognizes the importance of Health Safety and Environment aspect in performing the company's activities.



CORPORATE SOCIAL RESPONSIBILITY



RE cares for communities' need and welfare. Since established in 2001, RE through its mission and social programs have been providing not only the best engineering services for our customers, but also the best services to the surrounding communities. RE committed to grow together with the surrounding communities because it believe having a good relations with the surrounding communities is essential to create a better future. Its continuing commitment can be shown from Its social programs to the local communities which held annually, such as donation to orphans, poor community for their basic needs, toddlers for free immunization, blood donor and many more.



ENGINEERING SOFTWARE

RE realizes the importance of technology in carrying out its business by investing heavily on state of the art IT infrastructure to ensure an effective system of communication and collaboration. In order to accelerate working progress, RE utilizes information system technology which using intranet and internet network system. Therefore, all employees could communicate by electronic mail and construct an integrated information technology.

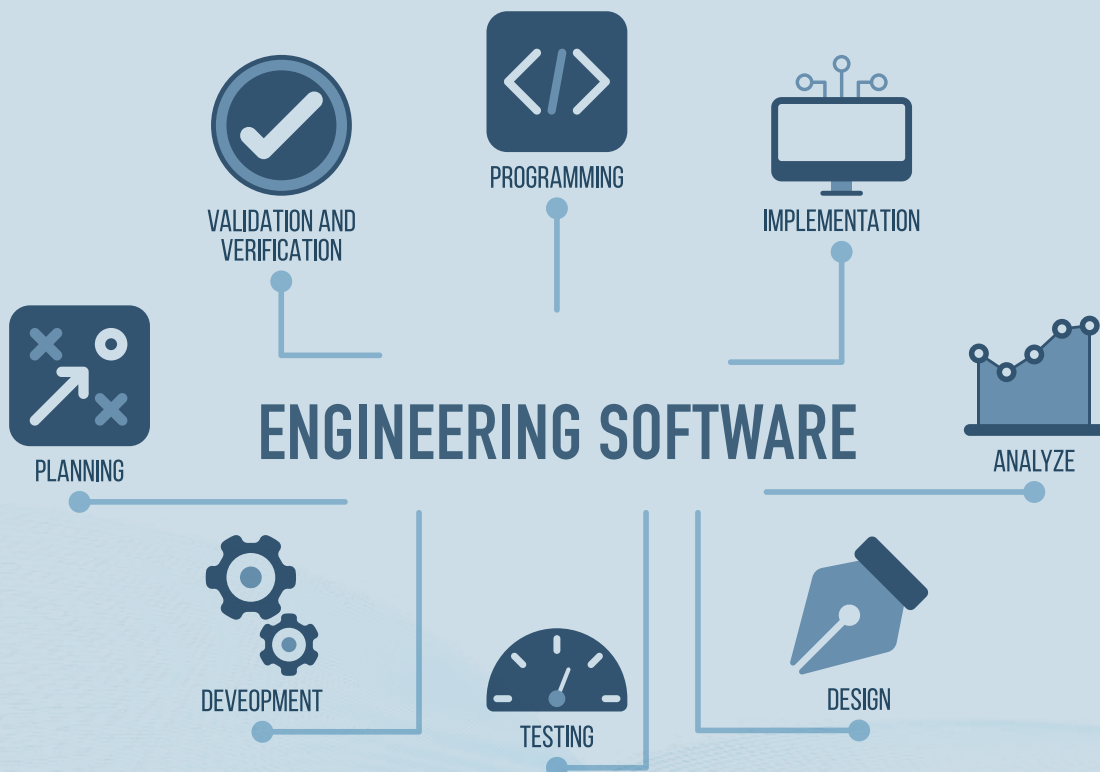

PROCESS

Aspen Hysys, PIPENET, Aspen Flare
System Analyzer

MECHANICAL

AMESTANK, Carrier HAP, Codeware
Compress, Siemens, Solid Edge,
Autodesk Inventor, Autocad
Mechanical

PIPING & 3D DESIGN

PDMS, AVEVA, Autodesk BIM
Doc, Hexagon PPM Smartplan,
AVEVA Navis Manage, Caesar II,
Smartplan, Autocad Plant 3D

PROJECT CONTROL

MS. Project, Primavera

CIVIL / STRUCTURE

STAADPRO, Tekla, Plaxis, Afes, Staad
Foundation, Matchcad, Sketchup,
Lumion, Robot Structure Analysis,
Autodesk Revit

ELECTRICAL

ETAP, Digsilent

INSTRUMENT

INSTRUCALC

CLIENTS



PARTNERS





GRAHA RE

Jl. Kalibata Timur II No. 27
Kalibata, Jakarta 12740
Indonesia

Telp. : +62-21 7918 1180

Fax. : +62-21 7940 984

marketing@re.rekayasa.co.id
corpsec@re.rekayasa.co.id



official pt rekayasa engineering



Rekayasa Engineering



twitptre



ptre_official